

PRO/MARK INDUSTRIALS

Div. R.D. Lewis Sales Limited

Lubrication & Fluid Handling Solutions

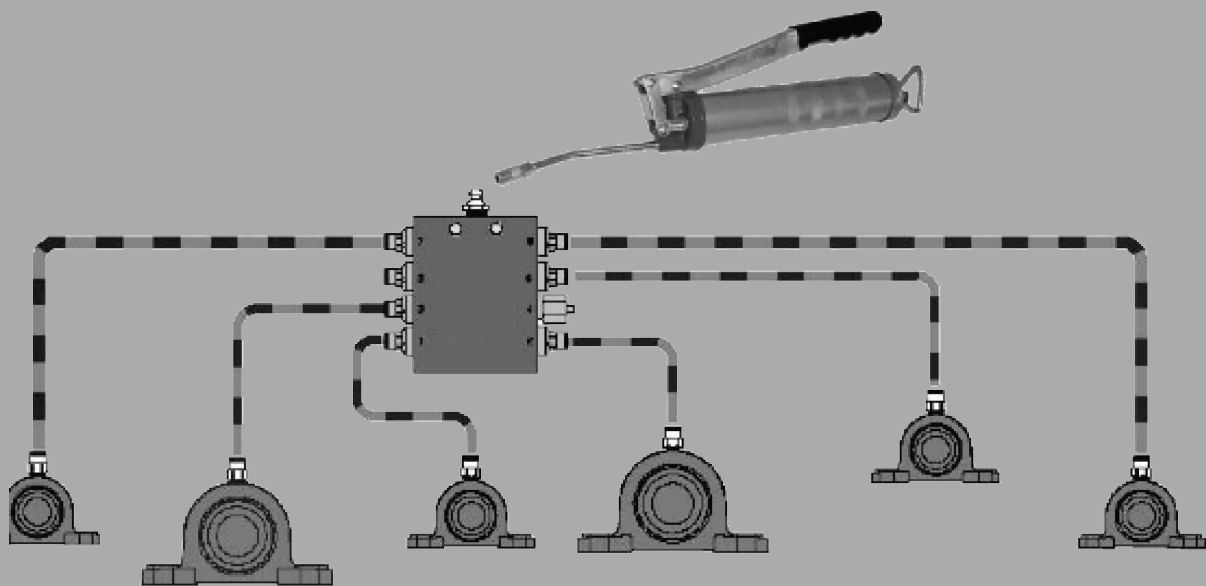
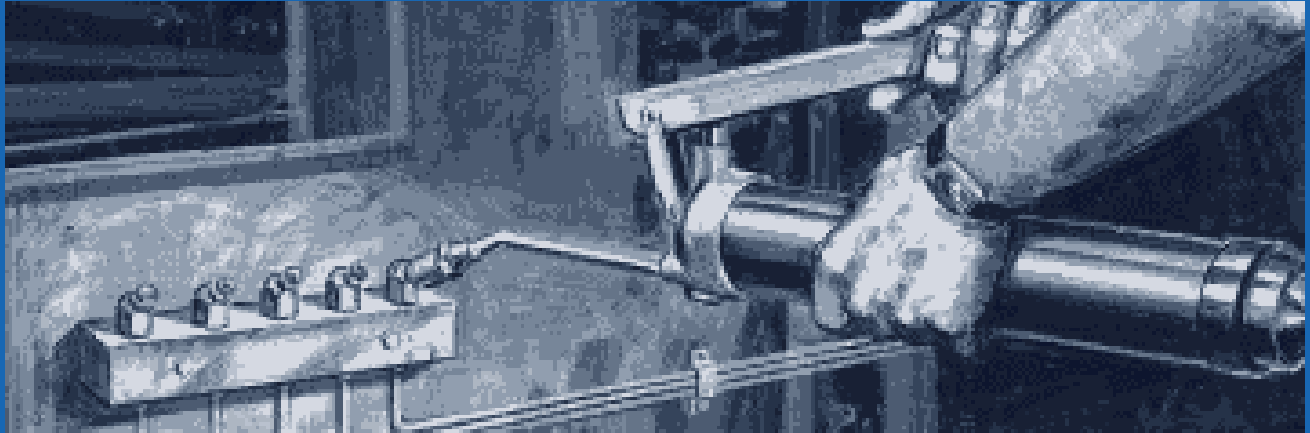

REMOTE LUBRICATION SYSTEMS

Remote Lube Fitting Systems

To enable easy lubrication of currently inaccessible or hazardous points

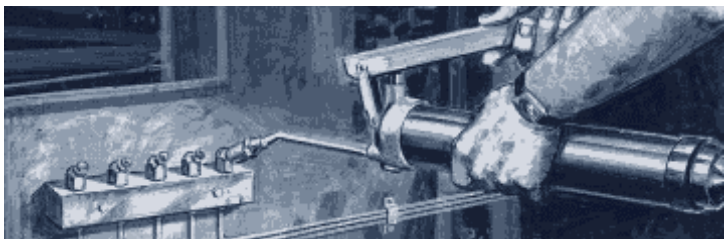

Hard to reach lubrication fittings present a major maintenance problem on all types of machinery.

Hidden or guarded lubrication fittings are often the cause of production down time.

High maintenance and operating costs are often directly traceable to poor lubrication fitting access.

REMOTE MANUAL LUBRICATION SYSTEMS ALLOWS:

Easy access to lubrication fittings

Quicker & Safer lubrication

Assurance that all bearings are lubricated

Bearings to be lubricated while the machine is operating

Hidden, inaccessible or hazardous bearings to be lubricated

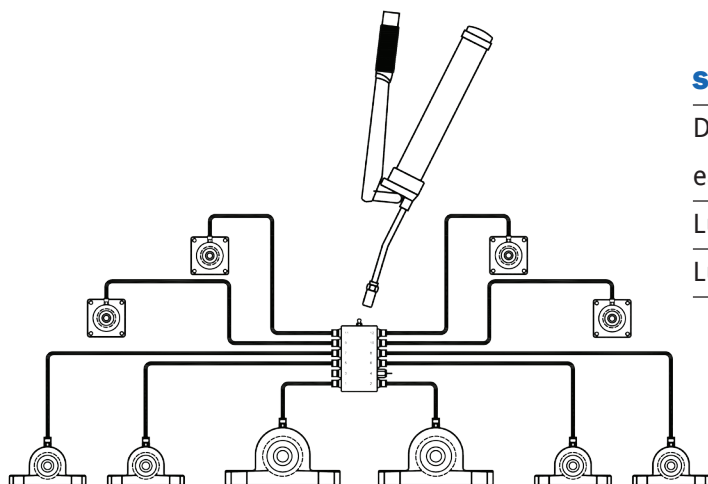

SINGLE POINT LUBRICATION KITS:

Deliver precise, controlled amounts of lubrication to each bearing point

Lubricate up to 18 pints in ONE MINUTE

Lubricate while the machine is operating

Junction Blocks

FEATURES AND BENEFITS

Hard to reach lubrication fittings present a major maintenance problem for the proper care of all types of machinery. Hidden or guarded lubrication fittings can mean production downtime, higher operating and maintenance costs and risk of personal injury to operators and employees - all directly traceable to poor lubrication fitting access. How do you eliminate these problems? ALT's Remote Lube Fitting Systems benefit you by providing easy access to lubrication fittings; lubrication is easier, quicker and safer; assures all bearings will be lubricated - and can be safely lubricated while machine is operating; and finally, it's possible to reach hidden, inaccessible or hazardous bearings.

JUNCTION BLOCK

Junction block surface mount systems are used to bring multiple lubrication points to a common, easily accessible location. The junction blocks provide a means for coupling lubricant feed lines to bearings with lubrication fittings and may be mounted in multiple units to meet all application requirements.

SF-LJB Junction Blocks have 9/32" diameter mounting holes at 90° intervals, for use with 1/4" diameter mounting bolts. This permits horizontal or vertical positioning of lubricant inlet passages.

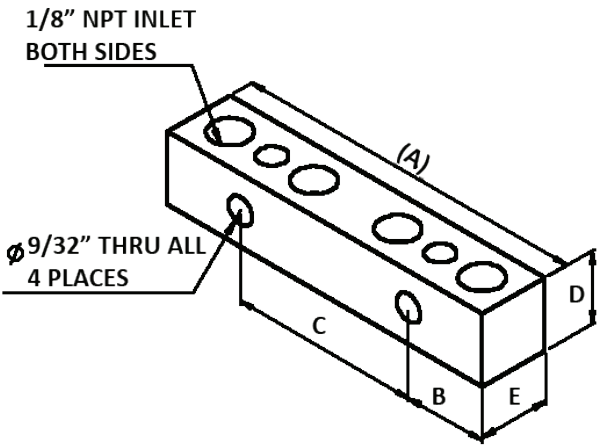
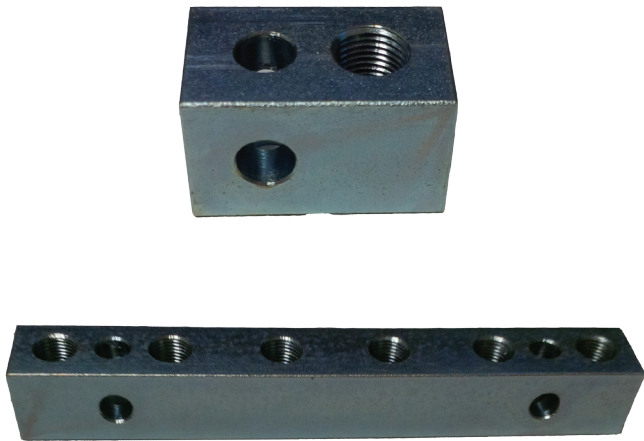

Junction Block Part No.	Number of Inlets	A in. (mm)	B in. (mm)	C in. (mm)	D in. (mm)	E in. (mm)
SF-LJB2-1	1	1.25 (31.75)	.375 (9.525)	N/A	.75 (19.05)	.75 (19.05)
SF-LJB2-2	2	1.75 (44.75)	.875 (22.225)	N/A	.75 (19.05)	.75 (19.05)
SF-LJB2-3	3	2.75 (69.85)	.875 (22.225)	1 (25.4)	.75 (19.05)	.75 (19.05)
SF-LJB2-4	4	3.75 (95.25)	.875 (22.225)	2 (50.8)	.75 (19.05)	.75 (19.05)
SF-LJB2-5	5	4.75 (120.65)	.875 (22.225)	3 (76.2)	.75 (19.05)	.75 (19.05)
SF-LJB2-6	6	5.75 (146.05)	.875 (22.225)	4 (101.6)	.75 (19.05)	.75 (19.05)

Other custom sizes available on request

Tube, Host & Fitting Configurations

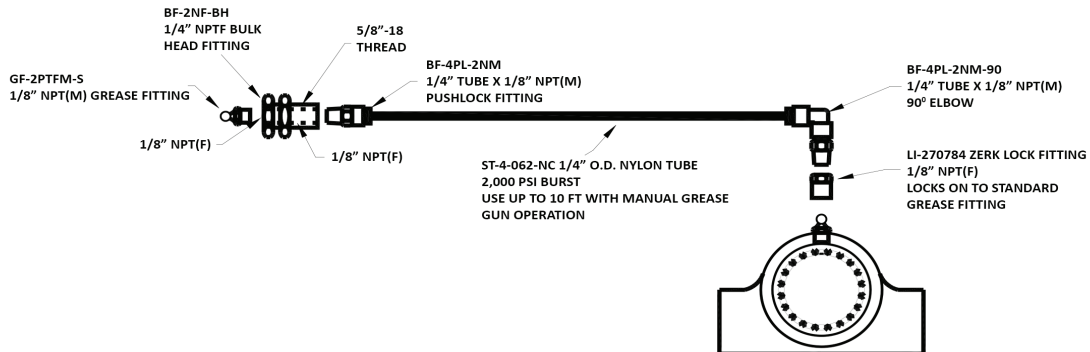
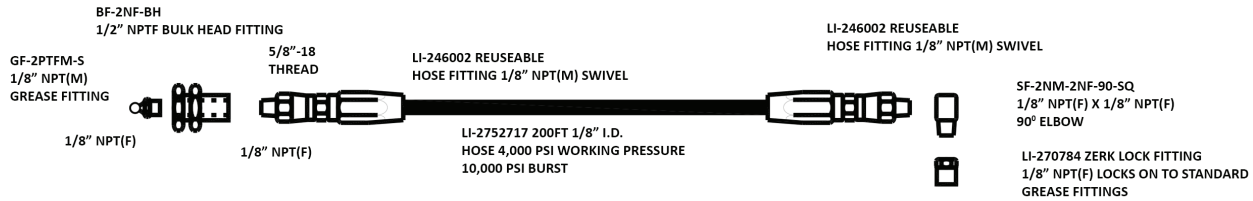
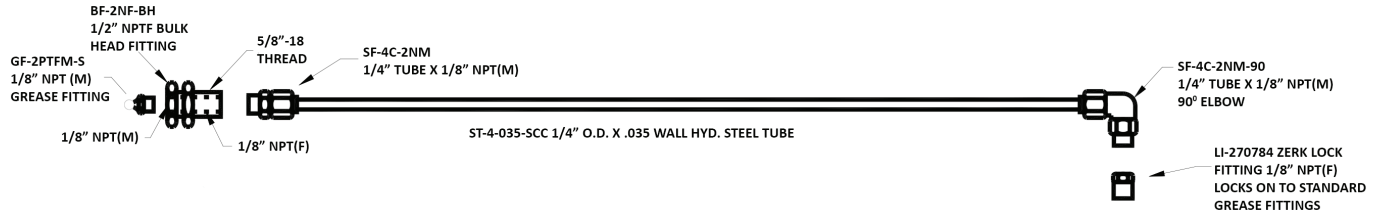

Zerk-Lock® Grease Fitting Adapter

FEATURES AND BENEFITS

Connects any 1/8" NPTF male tube adapter directly to a standard grease fitting. Aluminum, carbon steel construction; flourocarbons elastomer seal. Useful for connecting to drive-type fittings or metric fittings. Once installed, the Zerk-Lock cannot be removed from the fitting.

Part No.	Thread in. (mm)	Dimensions		
		A in. (mm)	B in. (mm)	C in. (mm)
LI-270784	1/8" NPSL Female	.625 (15.9)	.500 (12.7)	.500 (12.7)

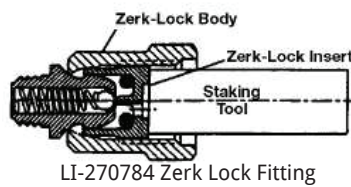
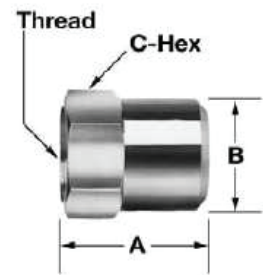

GF-ZLST Staking Tool

The Zerk-Lock grease fitting adapter permanently clamps to the head of any grease fitting including metric sizes. The adapter simplifies the installation of remote plumbed tubes to the lube point. No need to worry about matching grease fitting thread or struggling to remove difficult fittings.



1 Position Zerk-Lock over grease fitting.



2. Lock the Zerk-Lock onto the grease fitting using a hammer and a staking tool - a 3/8" drift punch or 3/8" diameter round bar.



3. Thread a tube fitting with a 1/8" NPT male thread fully locked into the Zerk-Lock.



4. Install tube into tube fitting.

Tube Clamps



Clamp No.	Tube Size O.D.	Number of Tubes	Distance Between Holes in. (mm)	Width in. (mm)	Length in. (mm)	Suggested Screw Size
TC-4X1	¼"	1	N/A	.50 (12.70)	1.20 (30.50)	¼" Bolt
TC-4X2	¼"	2	1.43 (36.32)	.50 (12.70)	2.20 (55.88)	¼" Bolt
TC-4X3	¼"	3	1.625 (41.28)	.50 (12.70)	2.38 (60.50)	¼" Bolt
TC-4X4	¼"	4	1.825 (46.36)	.50 (12.70)	2.57 (65.35)	¼" Bolt



Part No.	Tube Size O.D.	No. of Tubes	Width in. (mm)	Length in. (mm)	Hole Diameter in. (mm)
TC-6X1	¾"	1	.50 (12.70)	1.28 (32.55)	¼" Bolt



Part No.	Description
HS-4SW-B	¼" ID Spiral Wrap, Black
HS-6SW-B	¾" ID Spiral Wrap, Black
HS-8SW-B	½" ID Spiral Wrap, Black
HS-12SW-B	¾" ID Spiral Wrap, Black
HS-16SW-B	1" ID Spiral Wrap, Black
HS-20SW-B	1¼" ID Spiral Wrap, Black
HS-24SW-B	1½" ID Spiral Wrap, Black

Quick Connect Installation Fittings

FEATURES AND BENEFITS

Installing lubrication systems can take a lot of time. Compared to screw type fittings, Push Lock connectors simplify and speed up the connection of lubrication points to remote mounted grease fittings.



Part No.	Description
BF-4PL-2NM	¼" Push Lock x ⅛" NPT(M) Straight Connector
BF-4PL-2NM-90S	¼" Push Lock x ⅛" NPT(M) 90 Degree Elbow
BF-4PL-428M-90	¼" Push Lock x ¼"-28 (M) 90 Degree Swivel Elbow
BF-4PL-428M-90S	¼" Push Lock x ¼"-28 90 Degree Elbow
BF-4PL-428M	¼" Push Lock x ¼"-28 Straight Connector
BF-4PL-4PL	¼" Push Lock x ¼" Tube Splicer Union
BF-4PL-2NM-90	¼" Push Lock x ⅛" NPT(M) 90 Degree Swivel Elbow

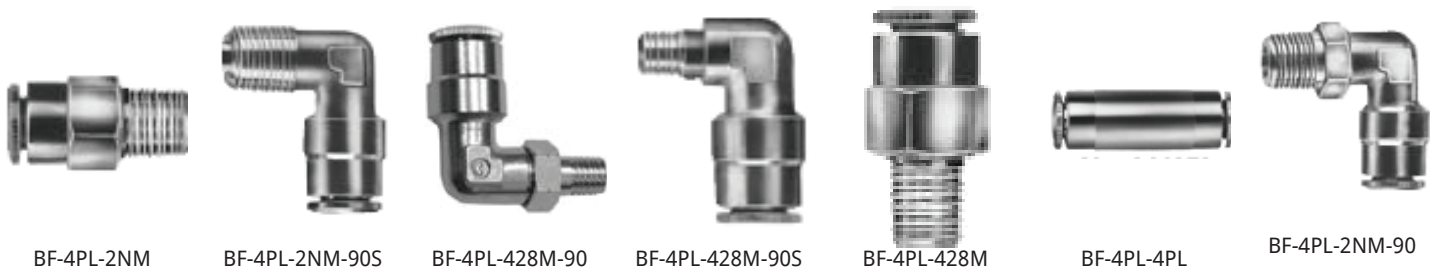

Part No.	Description	Unit of Measure
ST-1100H	¼" O.D. x .062 Wall Nylon Tube (647 psi working pressure)	per ft.
ST-4-035-S	¼" O.D. X 0.035" Wall (3000 psi working pressure)	per coil (25')

Feed Line Hose

⅛" I.D. x ⅝" O.D. Polyurethane Cover hose (4,000 psi working pressure –10,000 psi burst pressure)



LI-246002 1/8" NPT (M) Field Hose Coupling

Part No.	Length
LI-252717	200 FT
LI-241288	40 FT

E-Lube Single Point Lubrication Kits

Fully Monitored

Deliver precise, controlled amounts of lubricant to each bearing point

Lubricate up to 18 points in ONE MINUTE

Lubricate while the machine is operating

Quick, Simple Installation – all tubes & fittings supplied

Eliminate over and under lubrication

Free up maintenance personnel



Automate your system with an electric pump and reservoir package with or without integrated controller.

Tubes, fittings, clamps and mounting hardware included

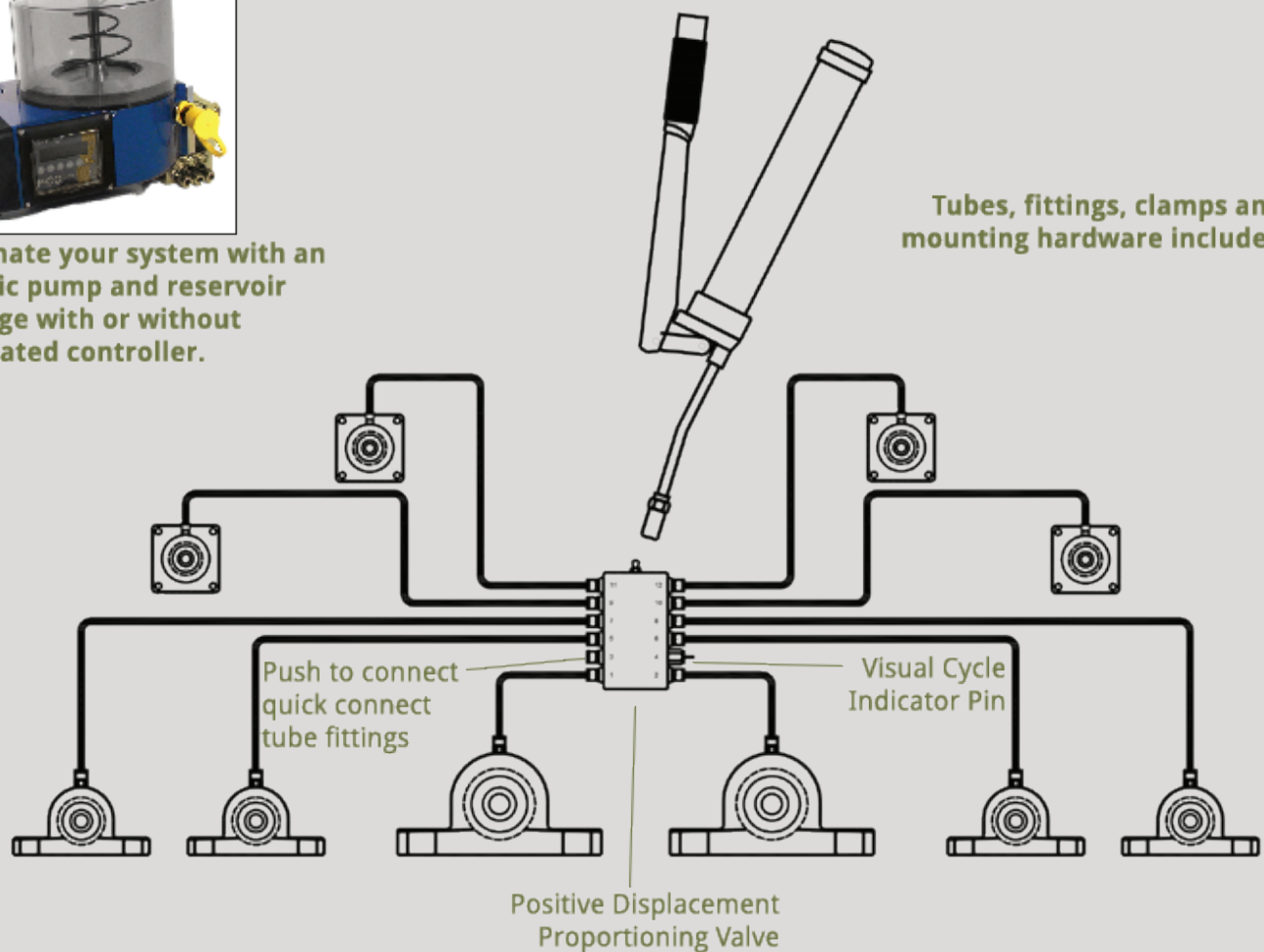

Product Data Sheet

Single Point Lubrication Kits

FEATURES AND BENEFITS

- The E-Lube system is designed to provide a relatively simple and inexpensive method of centralizing or automating the lubrication of machinery bearings.
- E-Lube can be a simple, centralized system with lubricant supplied manually from a lever grease gun.
- Pre-assembled kits are available to service up to 18 points from a single grease fitting.
- Custom kits can also be provided to service virtually any quantity of points - both manual and automated.
- E-Lube centralized systems dispense measured amounts of lubricant to each point in the system. Even those hard to reach fittings are assured of being properly lubricated and purged of contaminants.

SYSTEM OPERATION

1. The lubricant is delivered to the divider valve through a hand or power operated grease gun.

2. The divider valve takes the lubricant that it receives from the grease gun and proportions (divides) it off to the various lube points in the system in precisely measured amounts.
- It's easy to convert to or even start off with a fully automated, monitored system.

The automated grease pump is a simple and economical addition to the manual E-Lube system.

The divider valves come assembled to the pump.

Pumps come with a built in cycle controller and monitoring system.

One liter reservoir includes a low level indicator signal.

LED key pad provides simple and effective programming and monitoring of the system.

Manual System

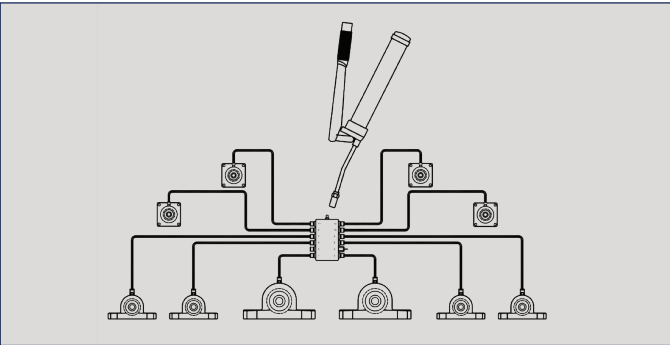

Single point kits include all items required to install a system on your application. The selection chart describes the models available to meet your specific needs.

Electric System

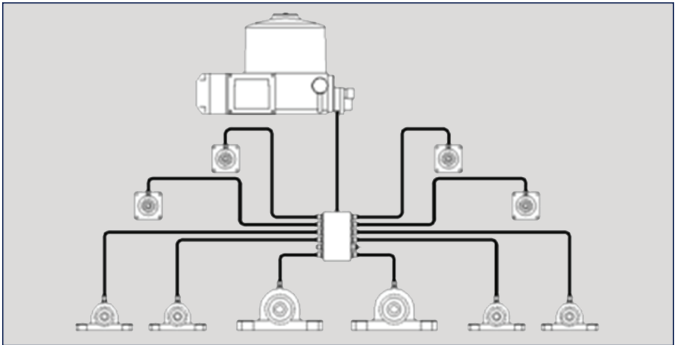

Kit Number	Description
7122-6M	2 to 6 point E-Lube manual system
7122-8M	2 to 8 point E-Lube manual system
7122-12M	2 to 12 point E-Lube manual system
7122-18M	6 to 18 point E-Lube manual system
7122-6M-G	2 to 6 point E-Lube manual system & lever grease gun
7122-8M-G	2 to 8 point E-Lube manual system & lever grease gun
7122-12M-G	2 to 12 point E-Lube manual system & lever grease gun
7122-18M-G	6 to 18 point E-Lube manual system & lever grease gun
7122-8A	2 to 8 point E-Lube automatic system 120 VAC
7122-12A	2 to 12 point E-Lube automatic system 120 VAC
7122-18A	6 to 18 point E-Lube automatic system 120 VAC